

# How to assemble the 4WD Audi R18 e-tron

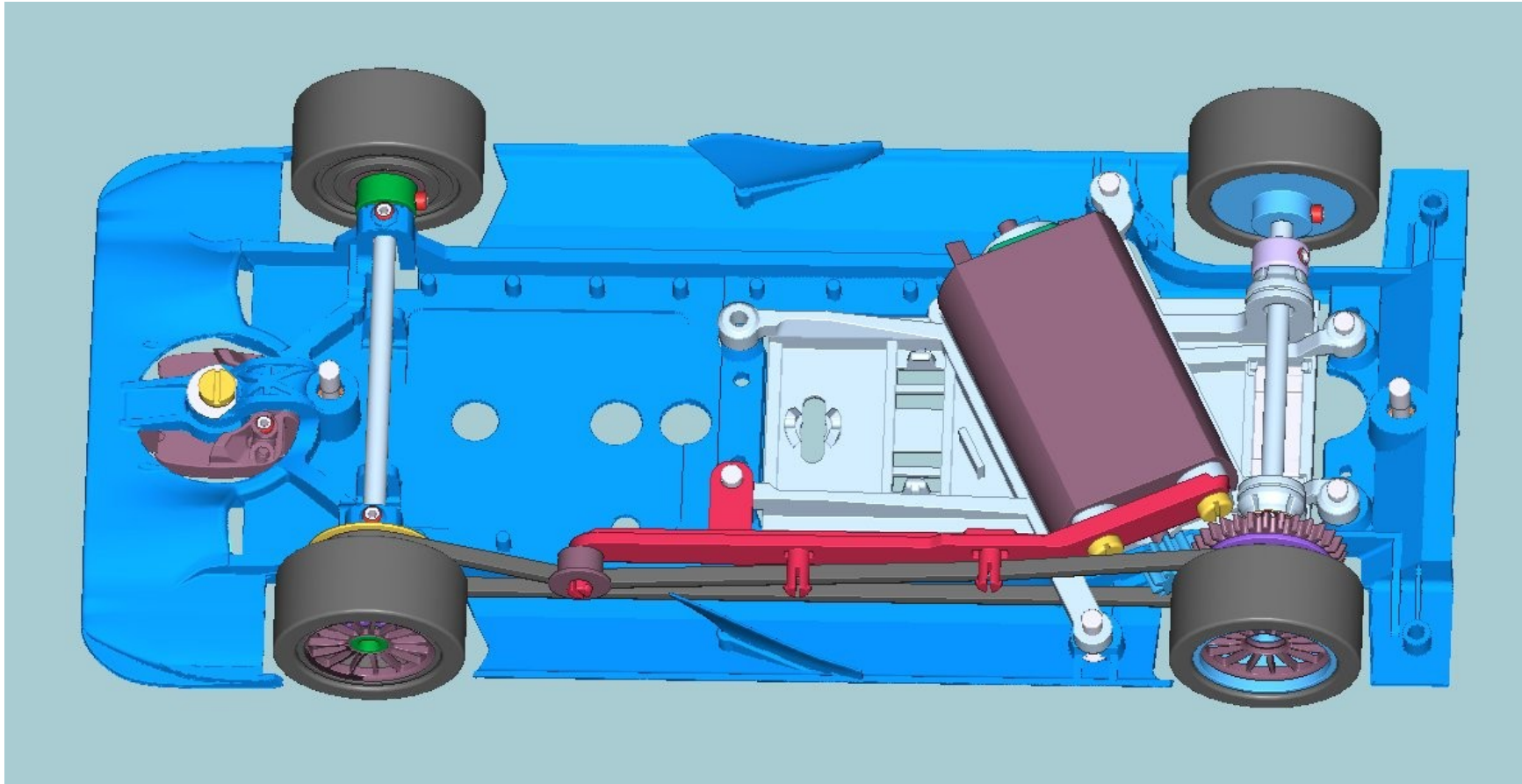

# Wheel assembly: front right

## FRONT RIGHT WHEEL

1) Insert bearing from the inside of the wheel

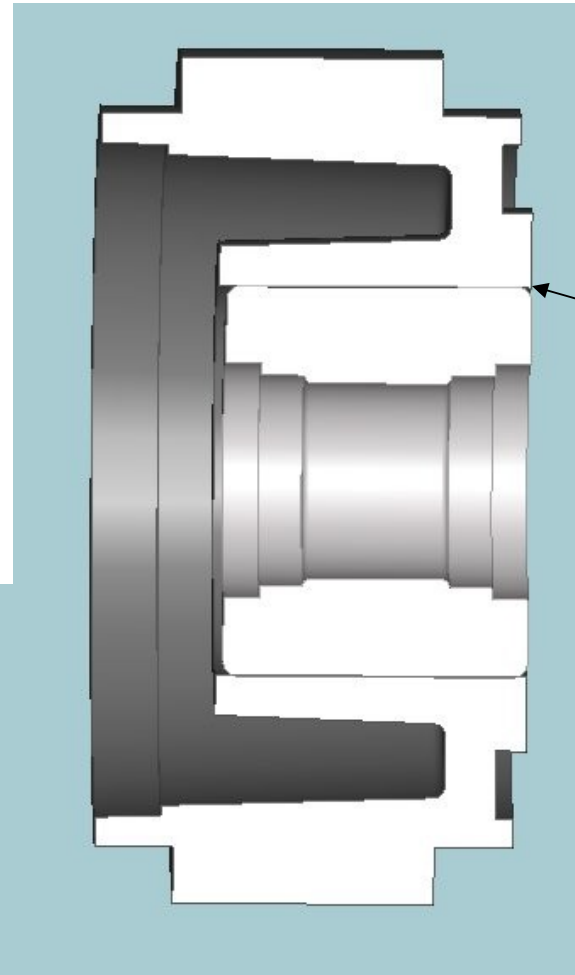
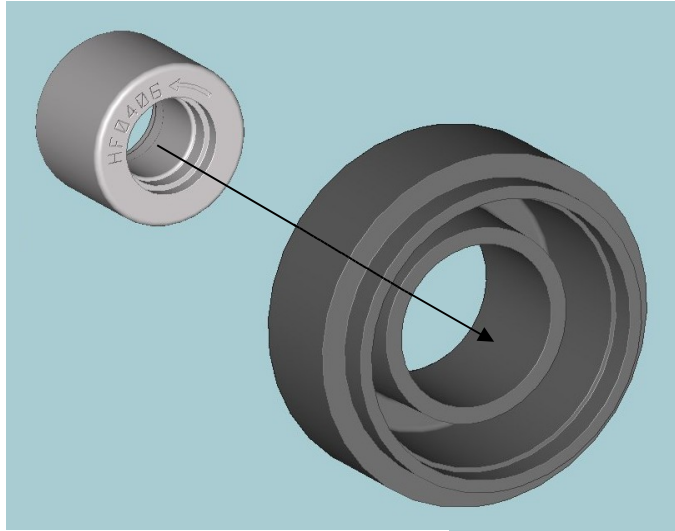

**Bearing must be aligned in the plastic wheel so that its inside surface is aligned with the inside surface of the plastic wheel.**

**Warning! the bearing in right front wheel must be assembled with the 'HF0406' writing facing OUTSIDE of the car!**

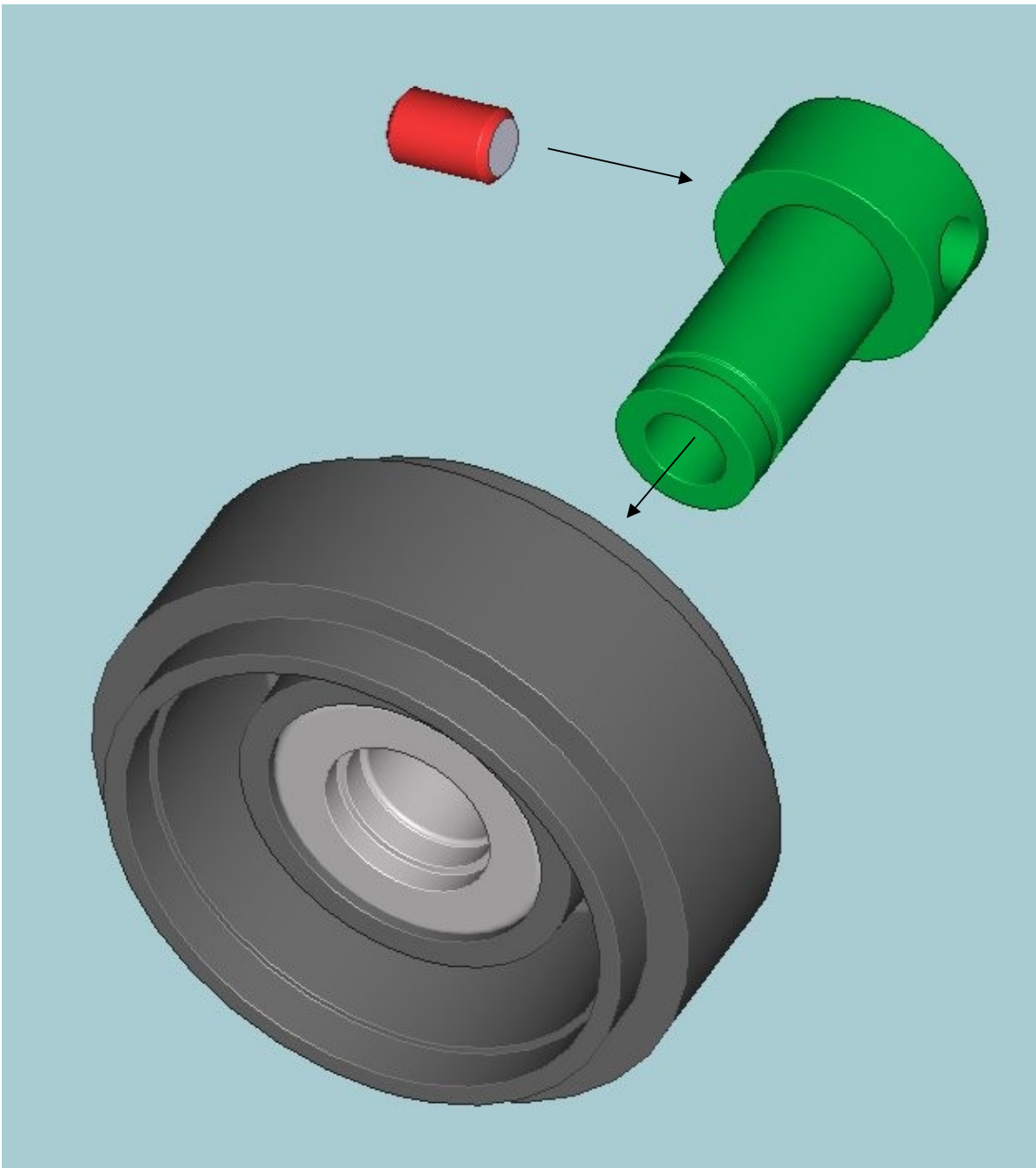

2 - Insert aluminium hub in the bearing, and insert the mini screw M2x3 in one of the two hub holes

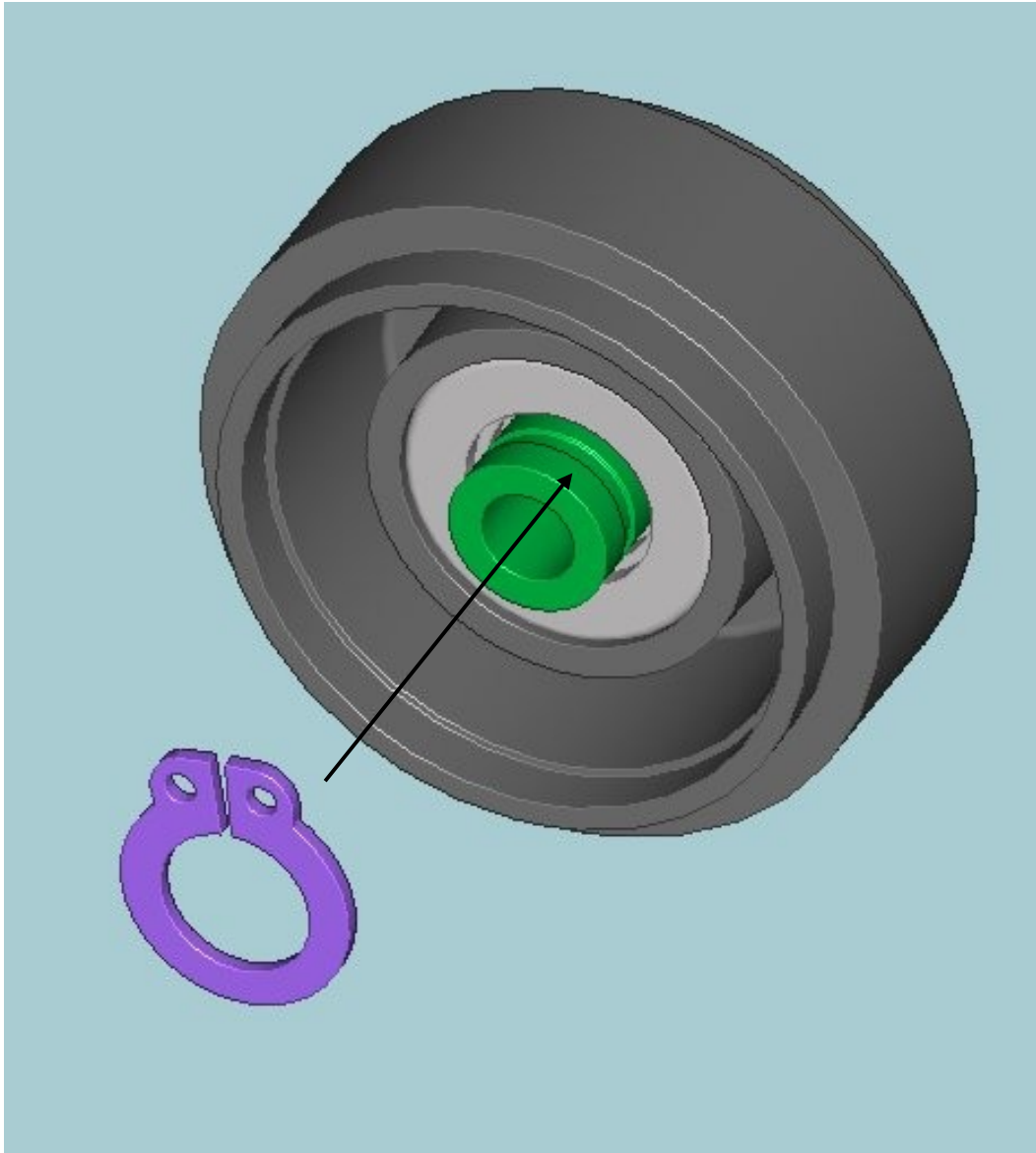

3 - Use the special seeger ring pliers to mount the seeger ring in the recessed guide, to assemble bearing and aluminium hub together.

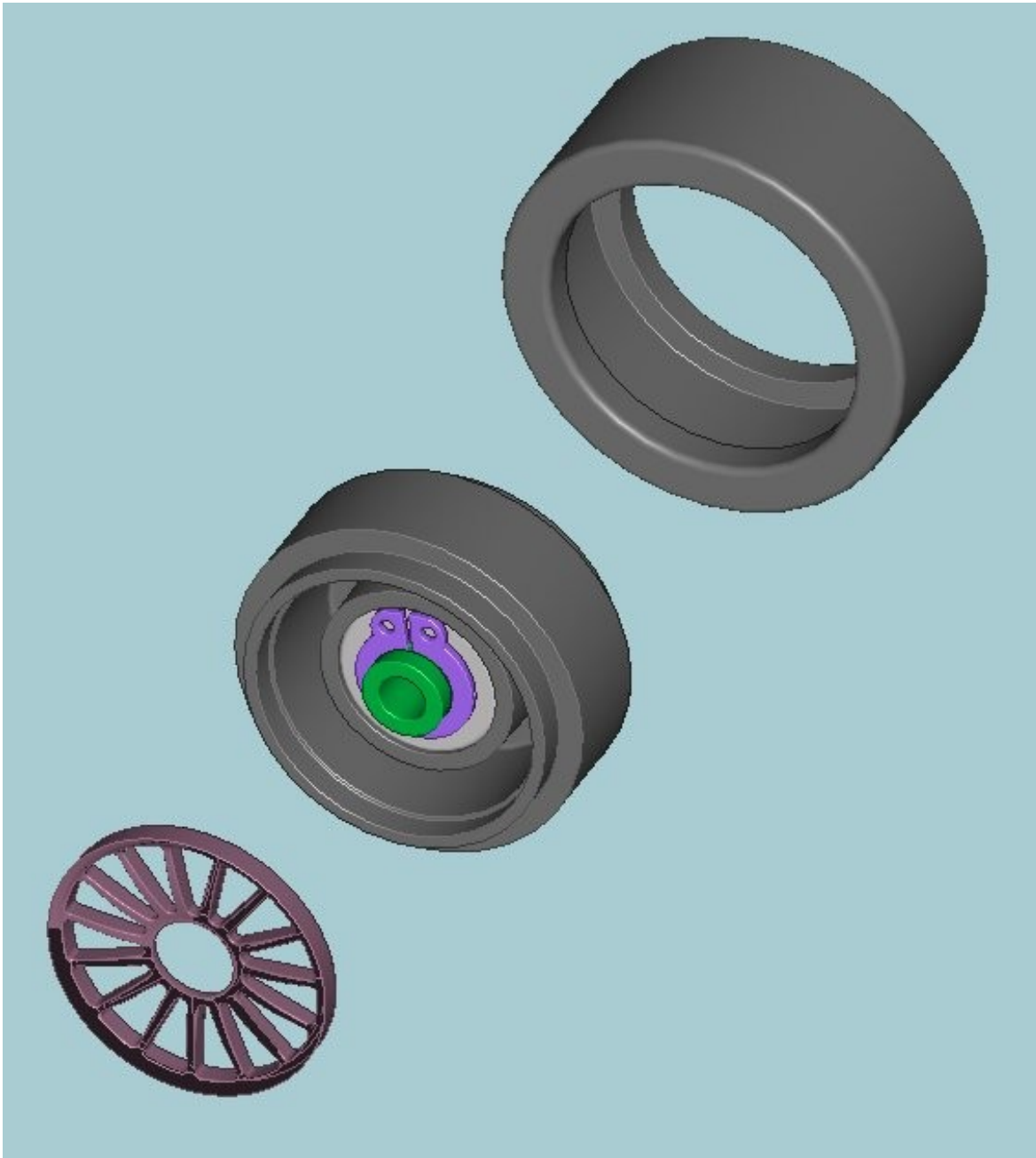

4 - Mount front wheel insert and tyre

# Wheel assembly: front LEFT

## FRONT **LEFT** WHEEL

5 - Insert bearing from the inside of the wheel

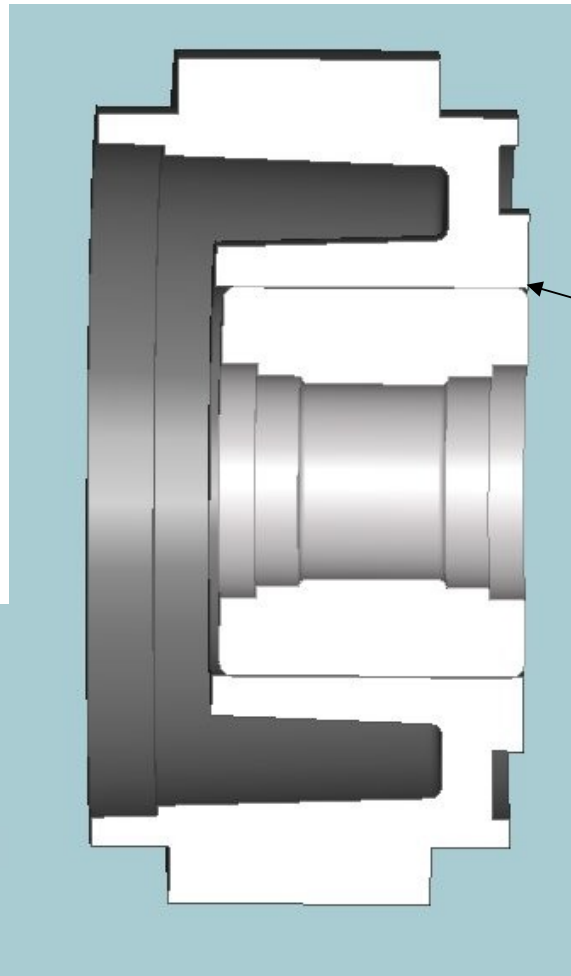
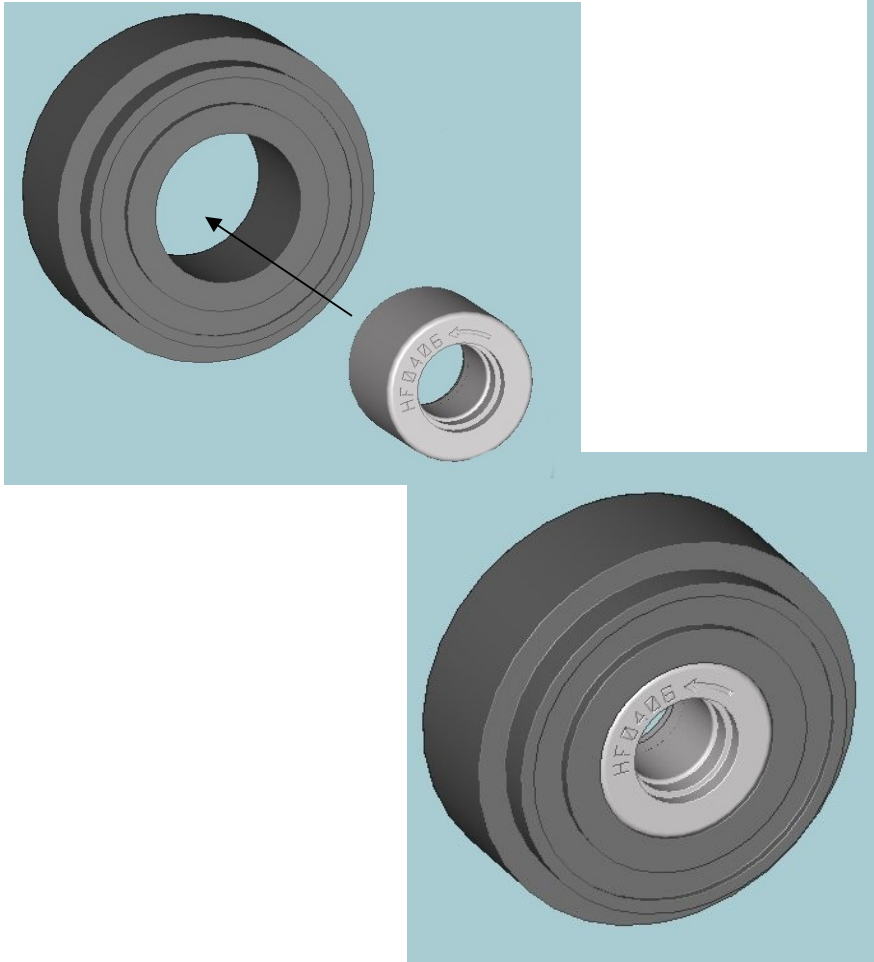

**Bearing must be aligned in the plastic wheel so that its inside surface is aligned with the inside surface of the plastic wheel.**

**Warning! the bearing in left front wheel MUST be assembled with the 'HF0406' writing facing INSIDE the car!**

then repeat steps 2,3,4 as done for the front right wheel

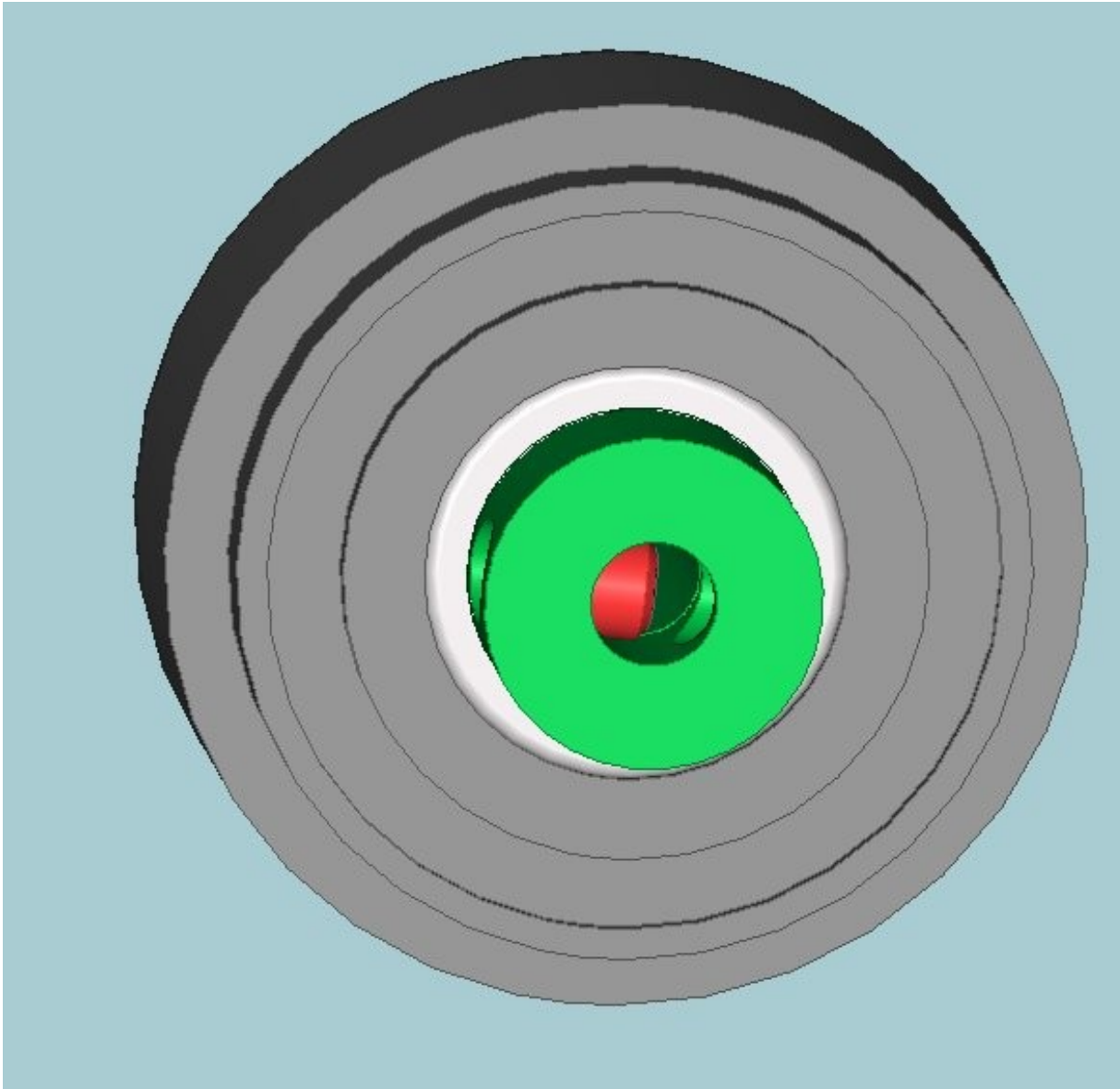

6) Insert mini screw in the front wheel hub all the way, until it's completely inside the aluminium hub

7) Press pulley with 17 teeth (2 dots on the back, see below) on the hub. The cut in the pulley must be aligned on top of the grub screw.

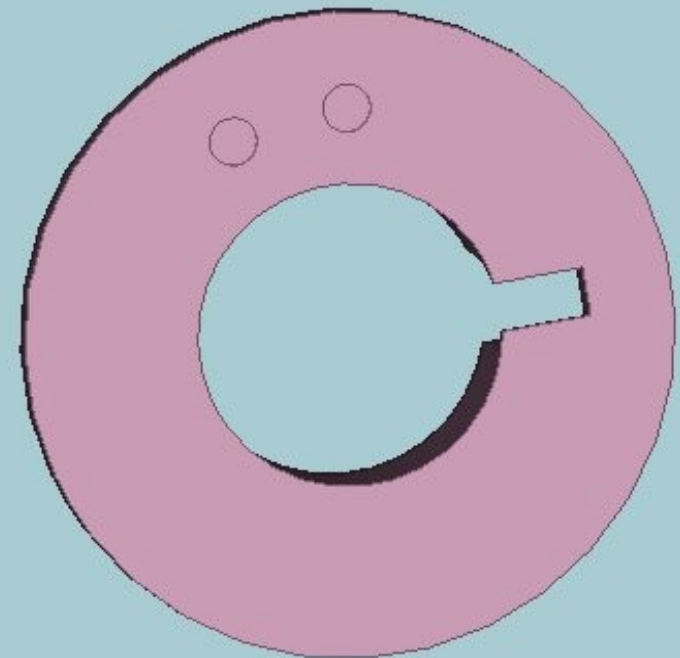
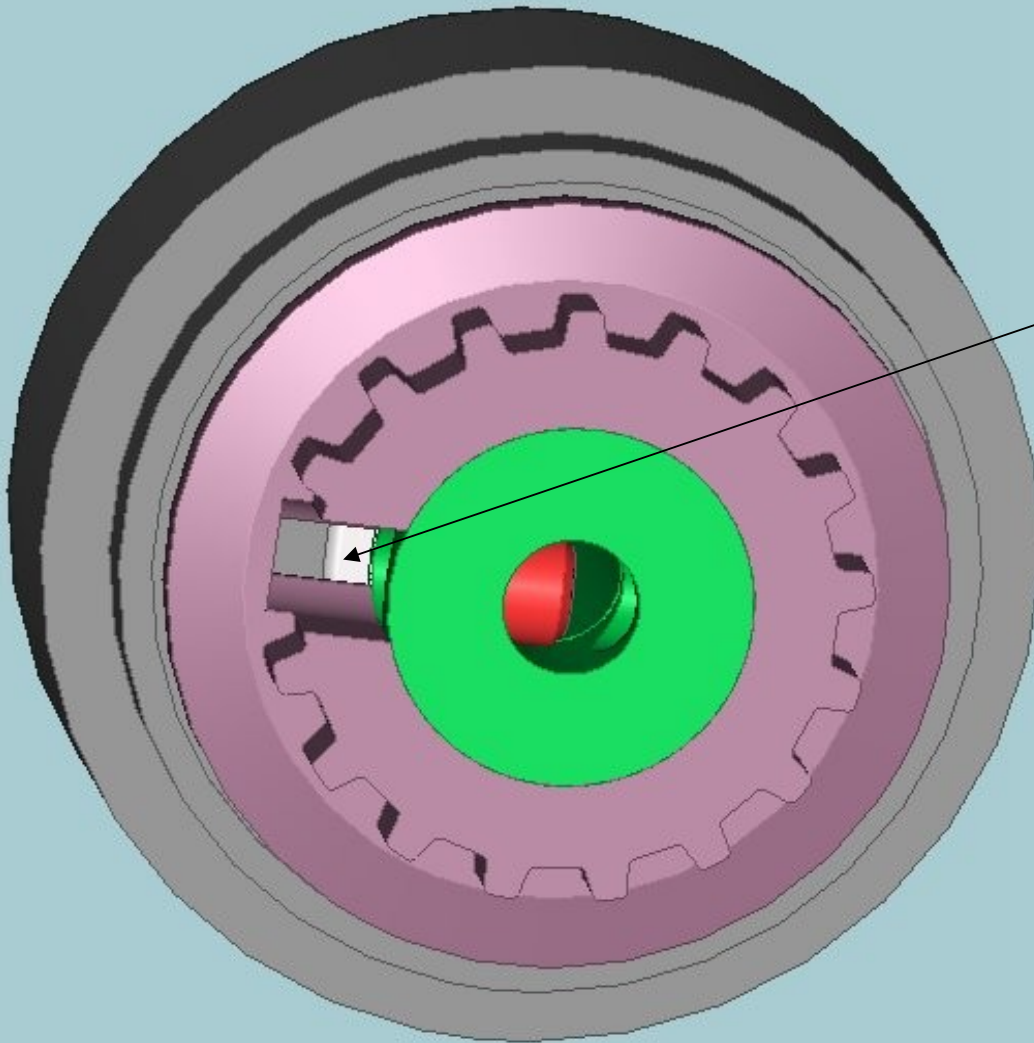



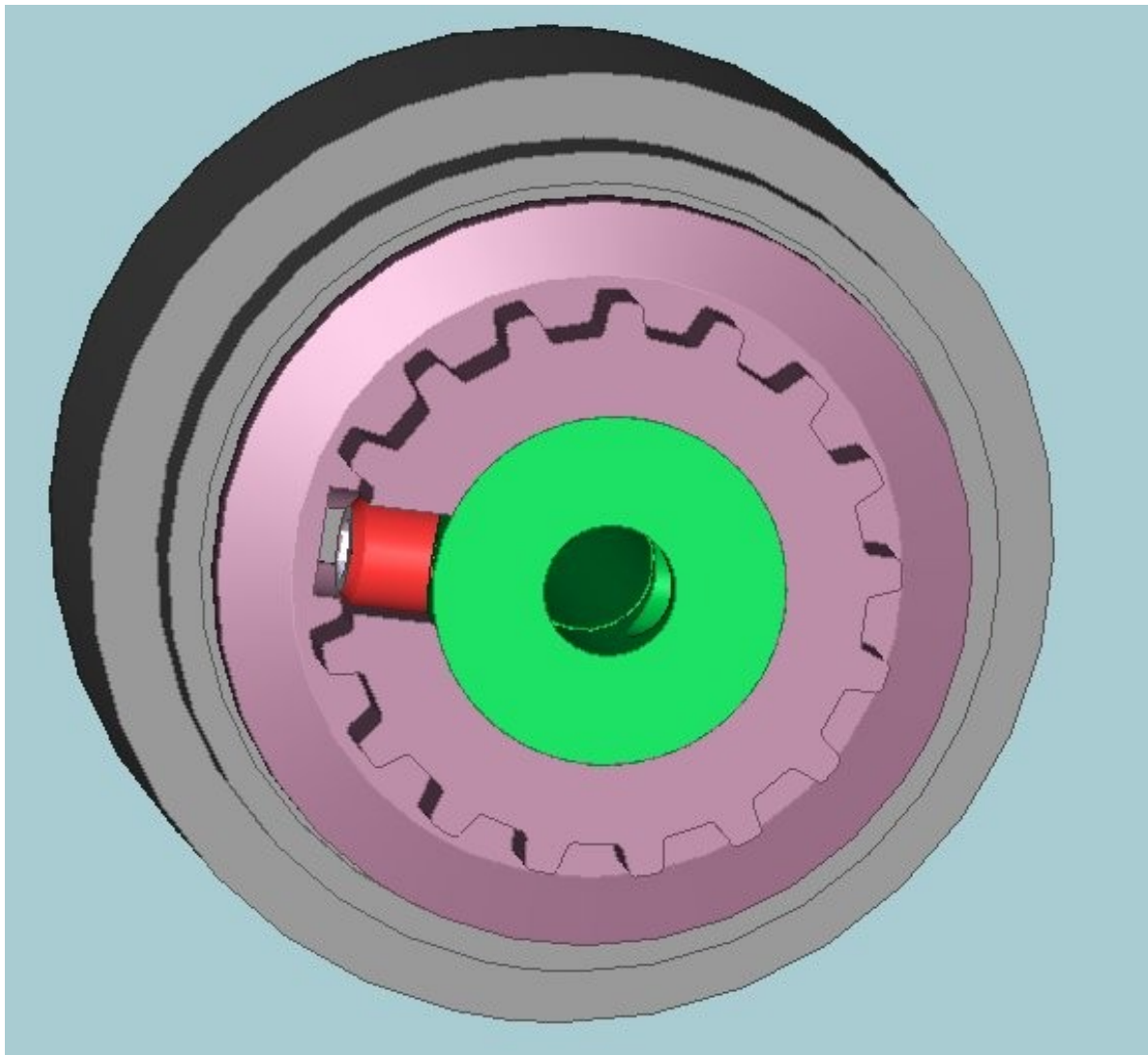

8) Unscrew the miniscrew so that the axle can be inserted in the front wheel.

## Wheel assembly: rear right

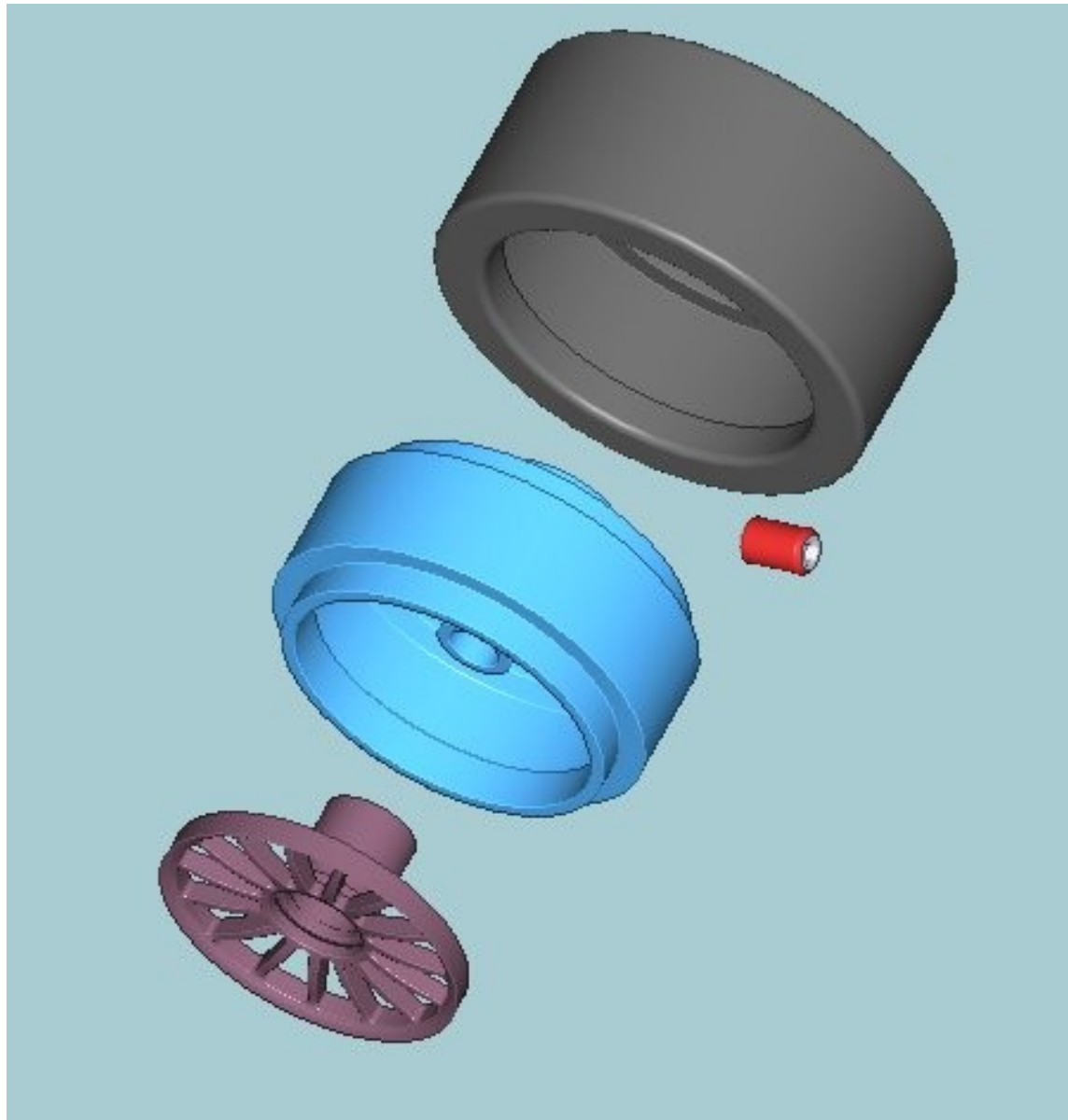

REAR **RIGHT** WHEEL  
9) This is a standard wheel  
- use tyres, aluminium hub,  
insert, mini screw

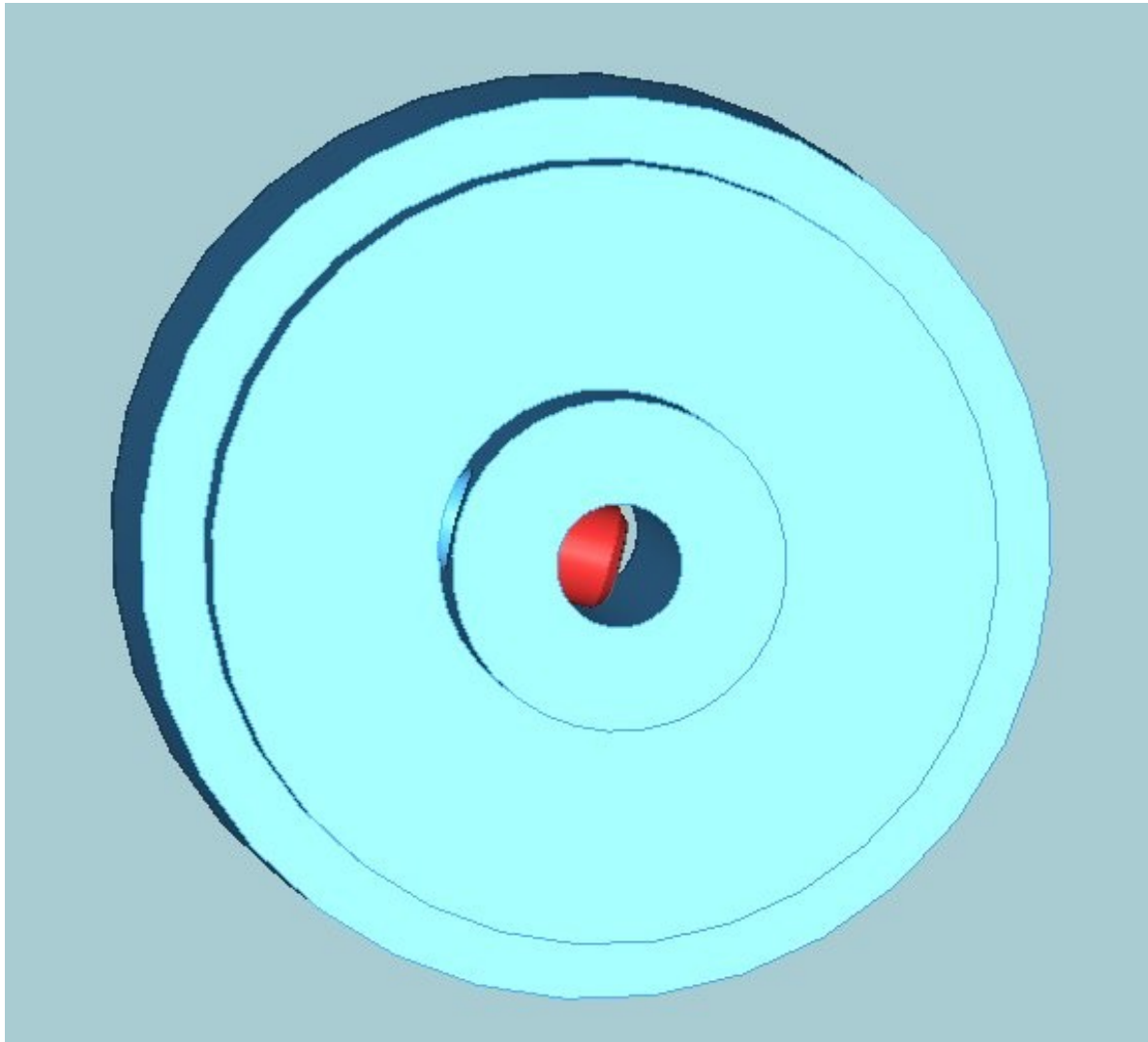

### REAR **LEFT** WHEEL

10) Same technique used for the front wheels:  
insert mini screw in the front wheel hub all the way, until it's completely inside the aluminium hub

11) Press pulley with **16 teeth** (1 dot on the back, see below) on the hub. The cut in the pulley must be aligned on top of the grub screw.

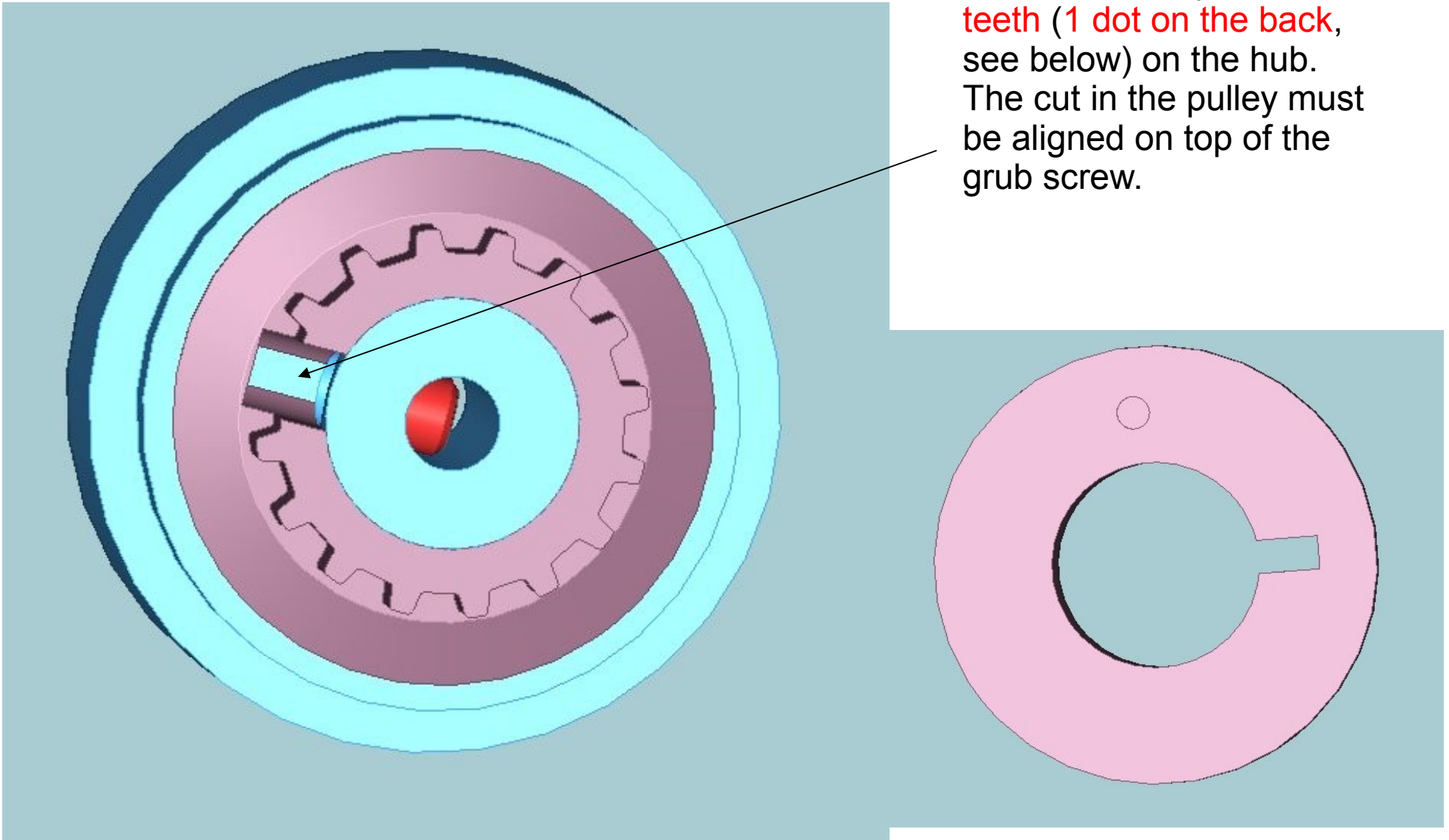

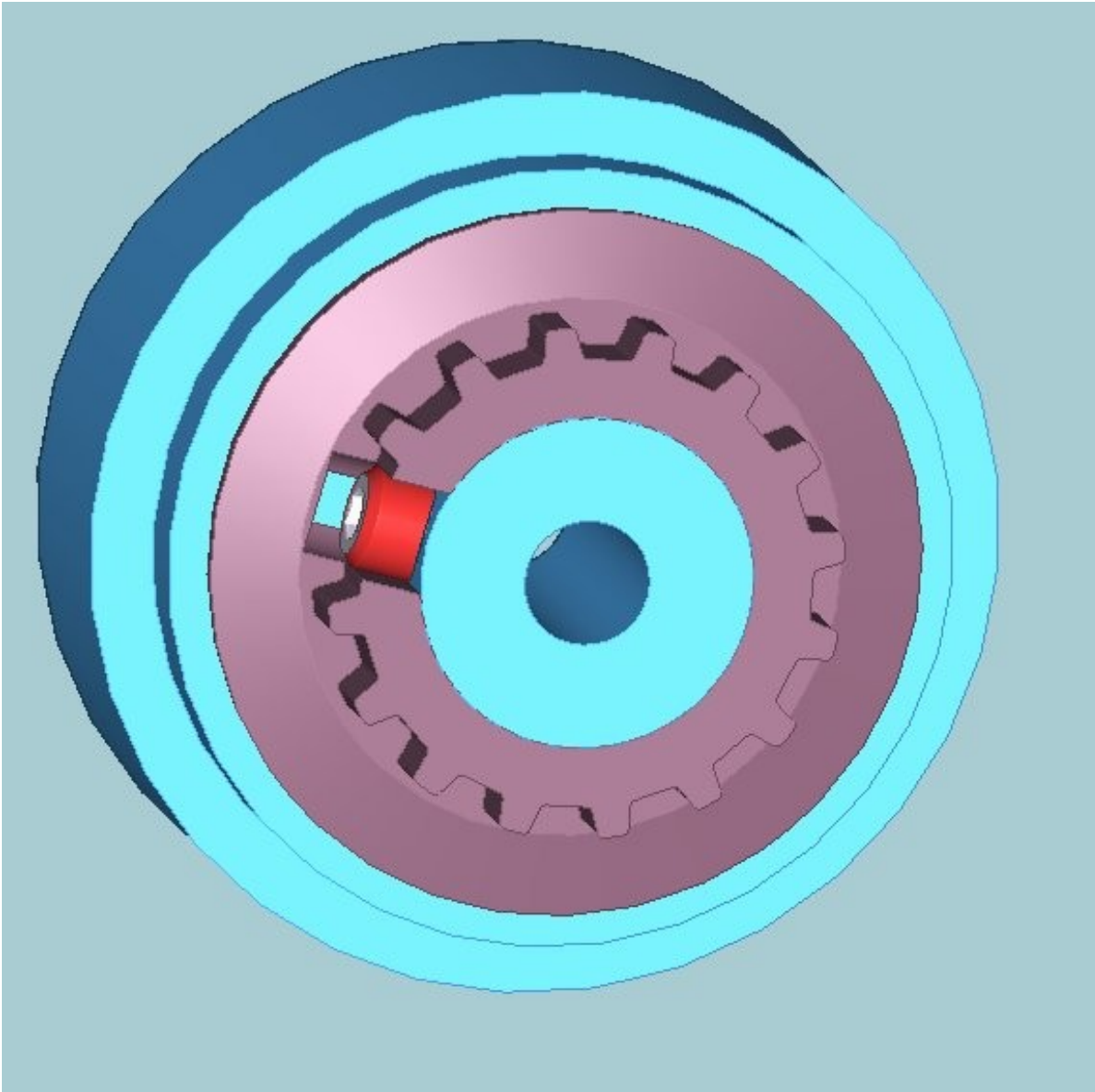

12) Unscrew the miniscrew so that the axle can be inserted in the rear wheel

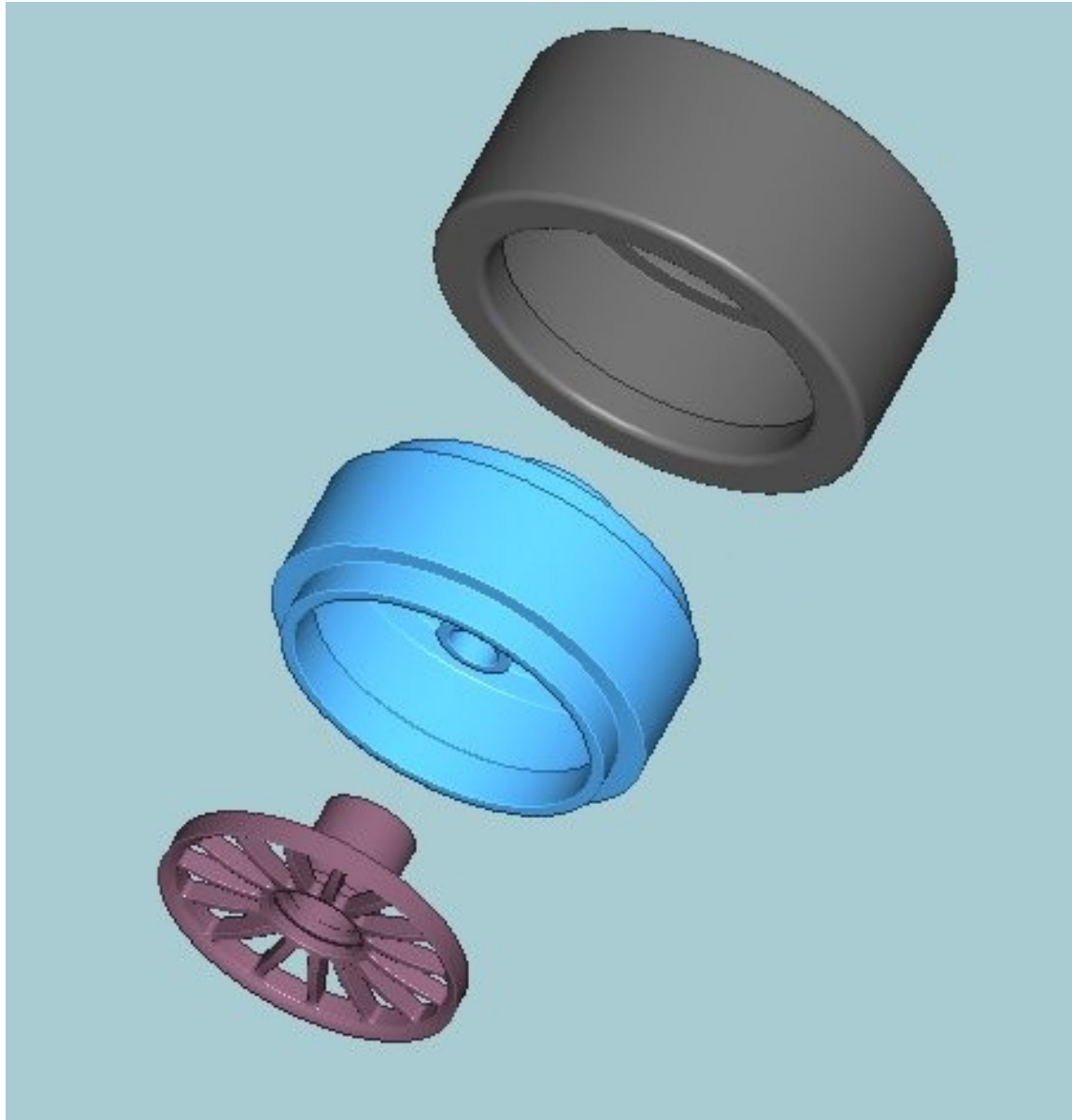

13) add tyre and wheel insert

## Motor mount assembly

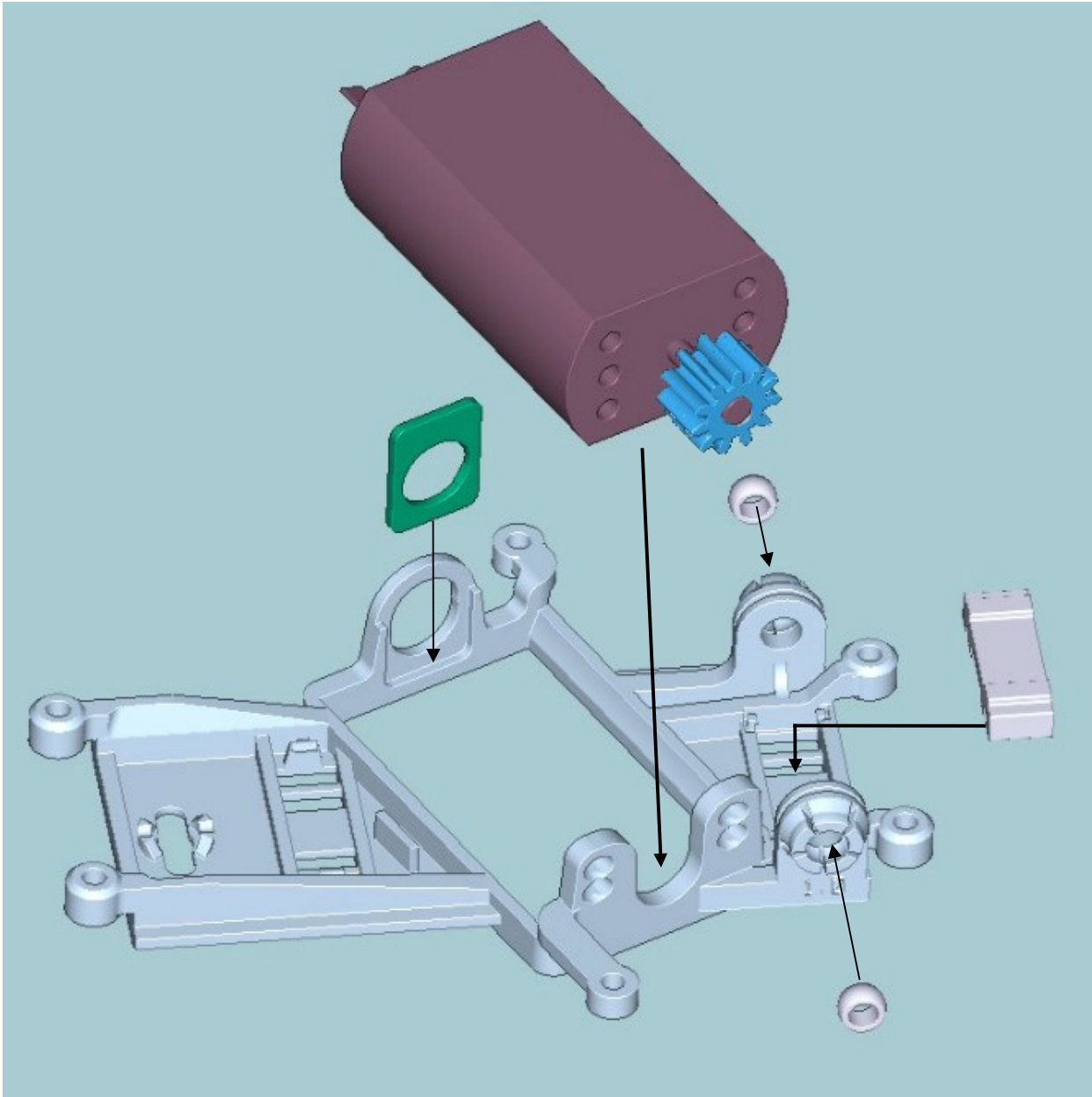

14) Add standard motor mount parts: motor, magnet, bushings, adapter

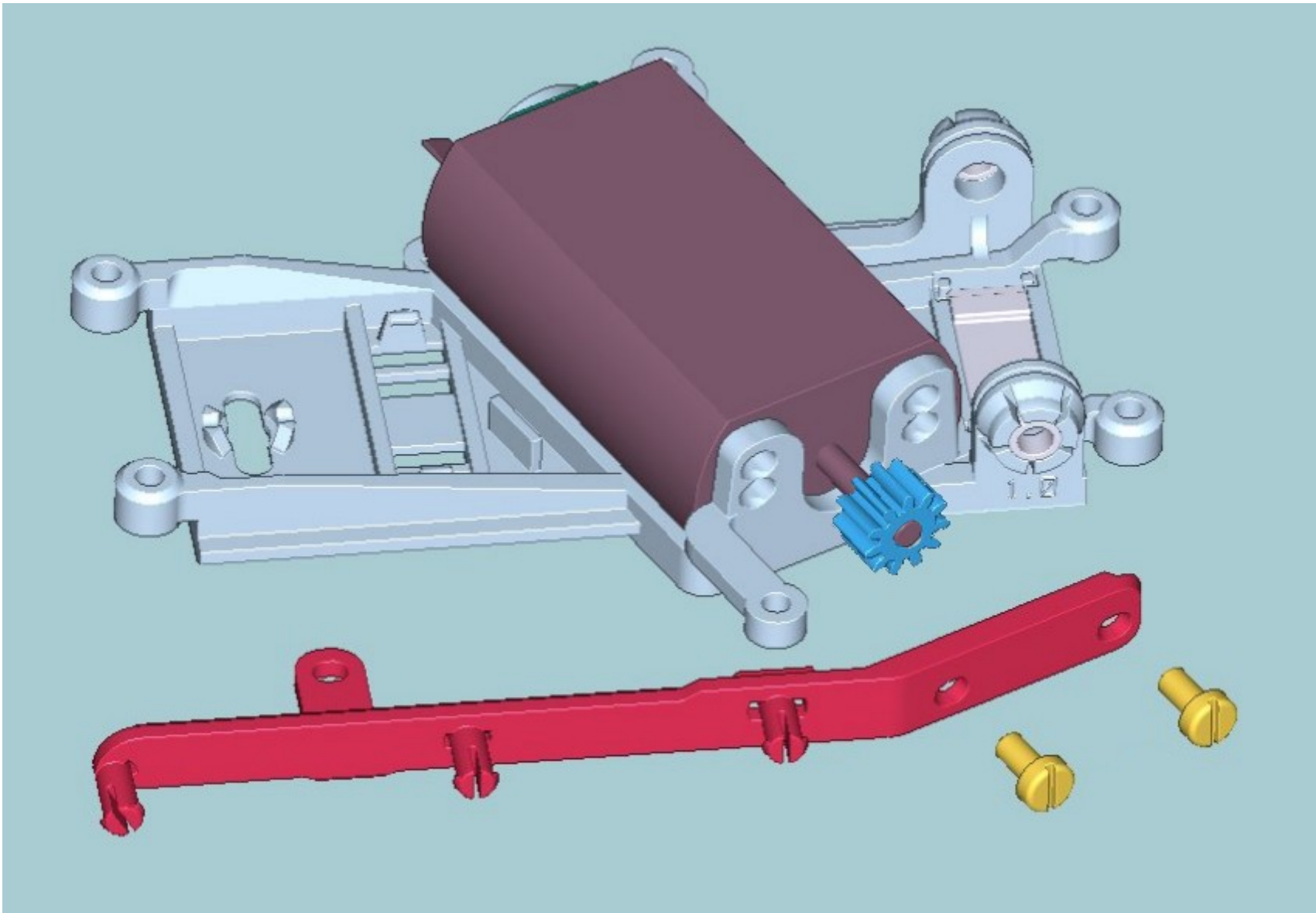

15) Screw the motor to the motor mount, keeping the pulley tensioner between the motor mount and the heads of the screws



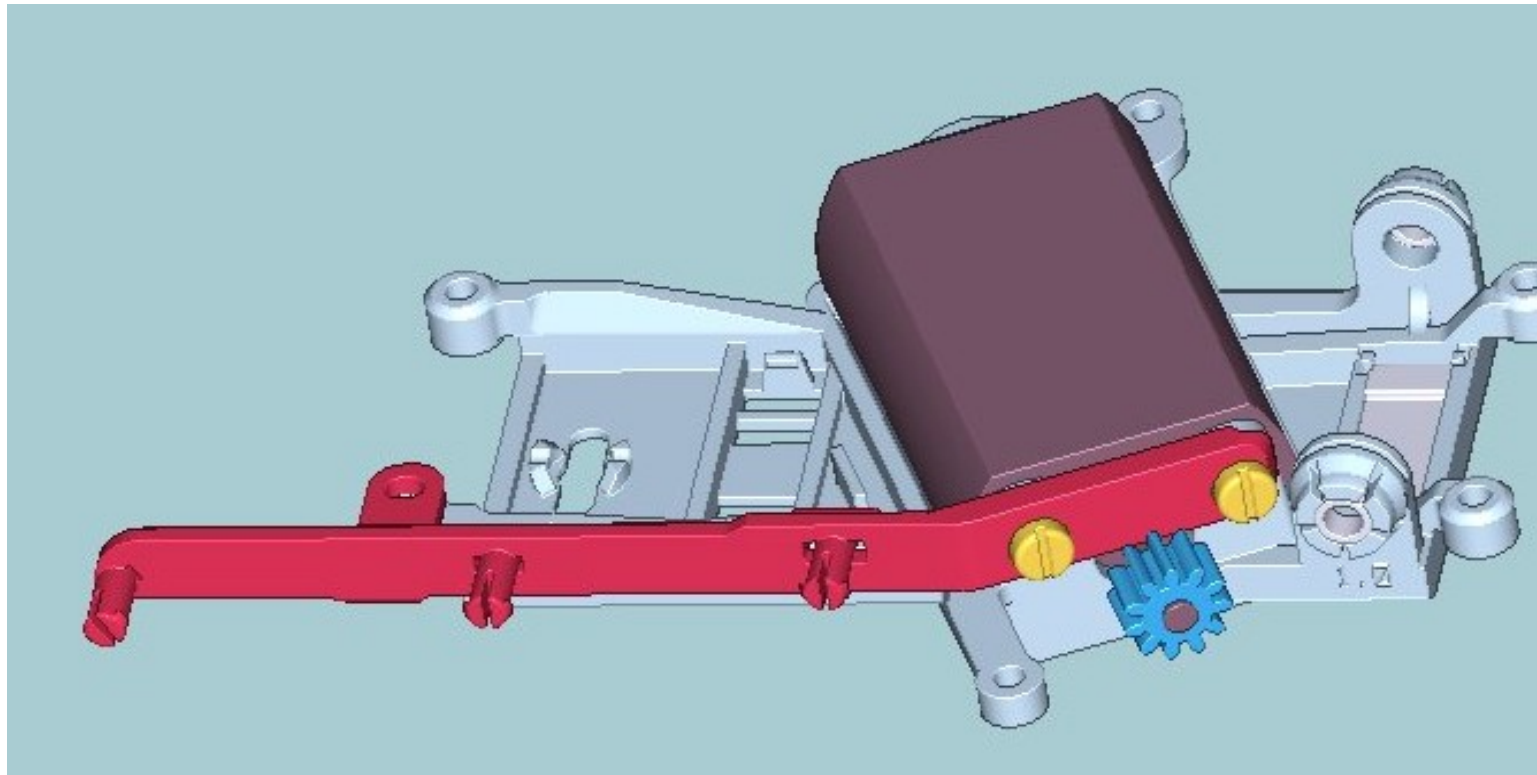

Final result

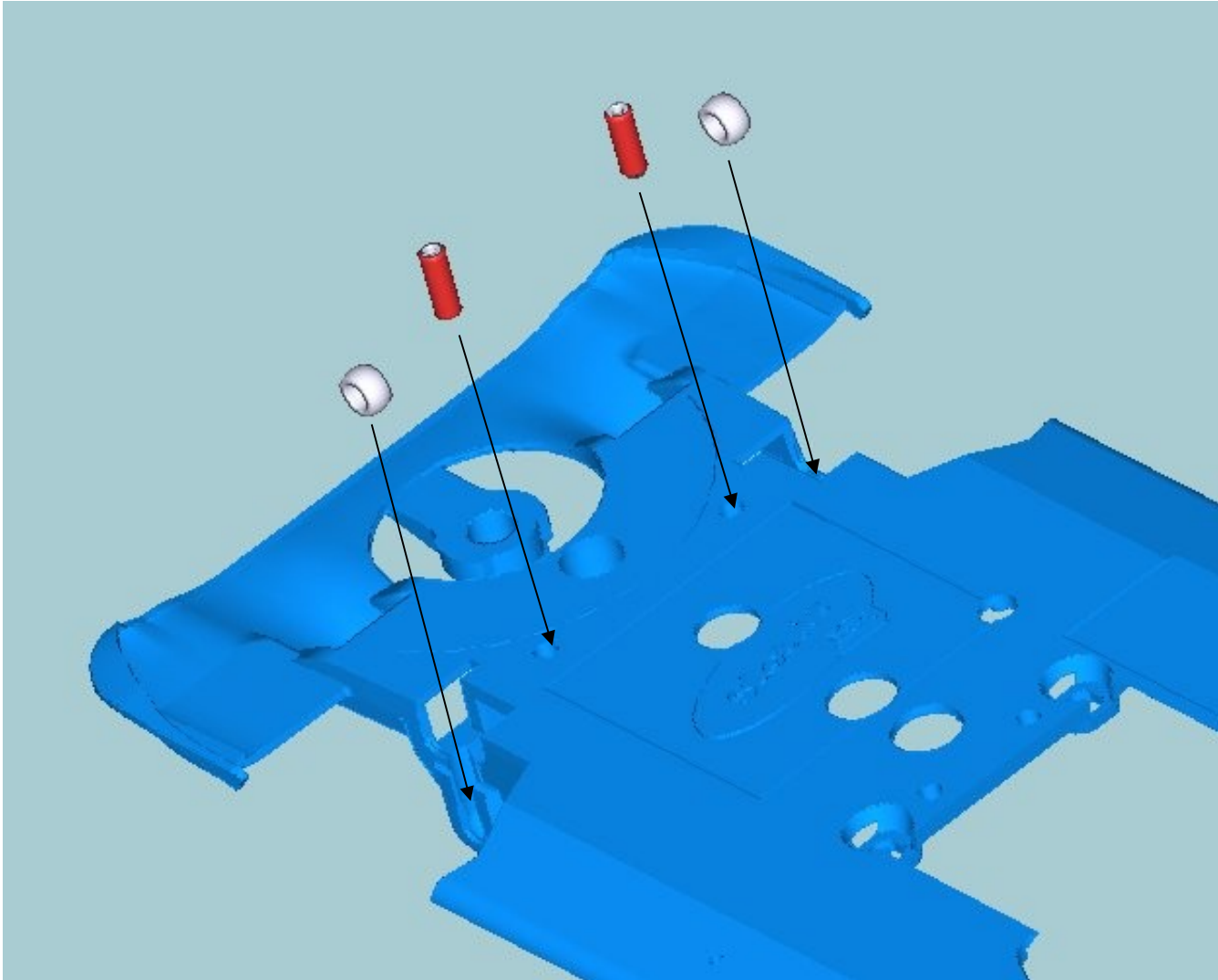

16) turn chassis upside down, and insert two 6mm mini screws in the special holes. Also add two bushings in the front axle supports.

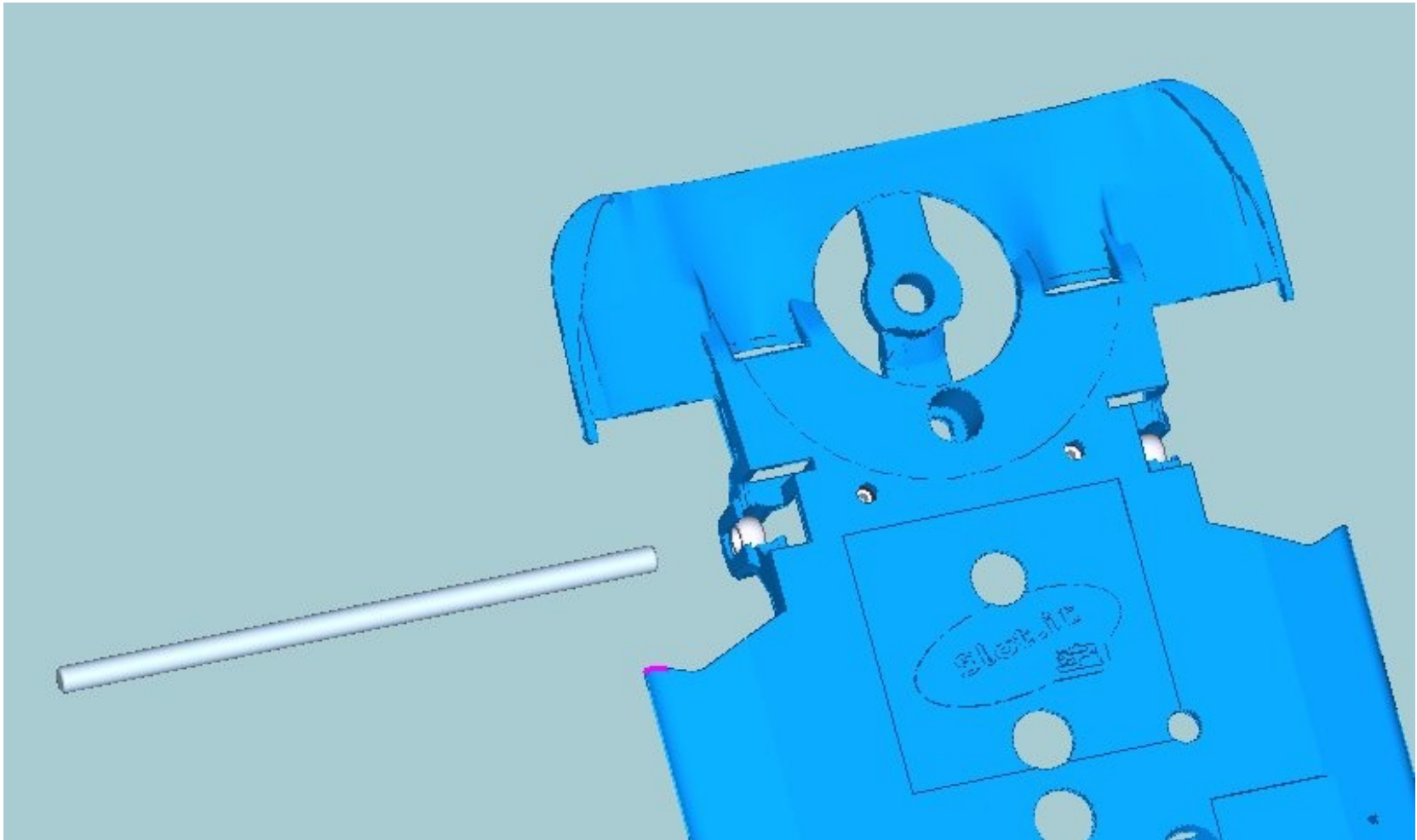

17) Add front shaft.

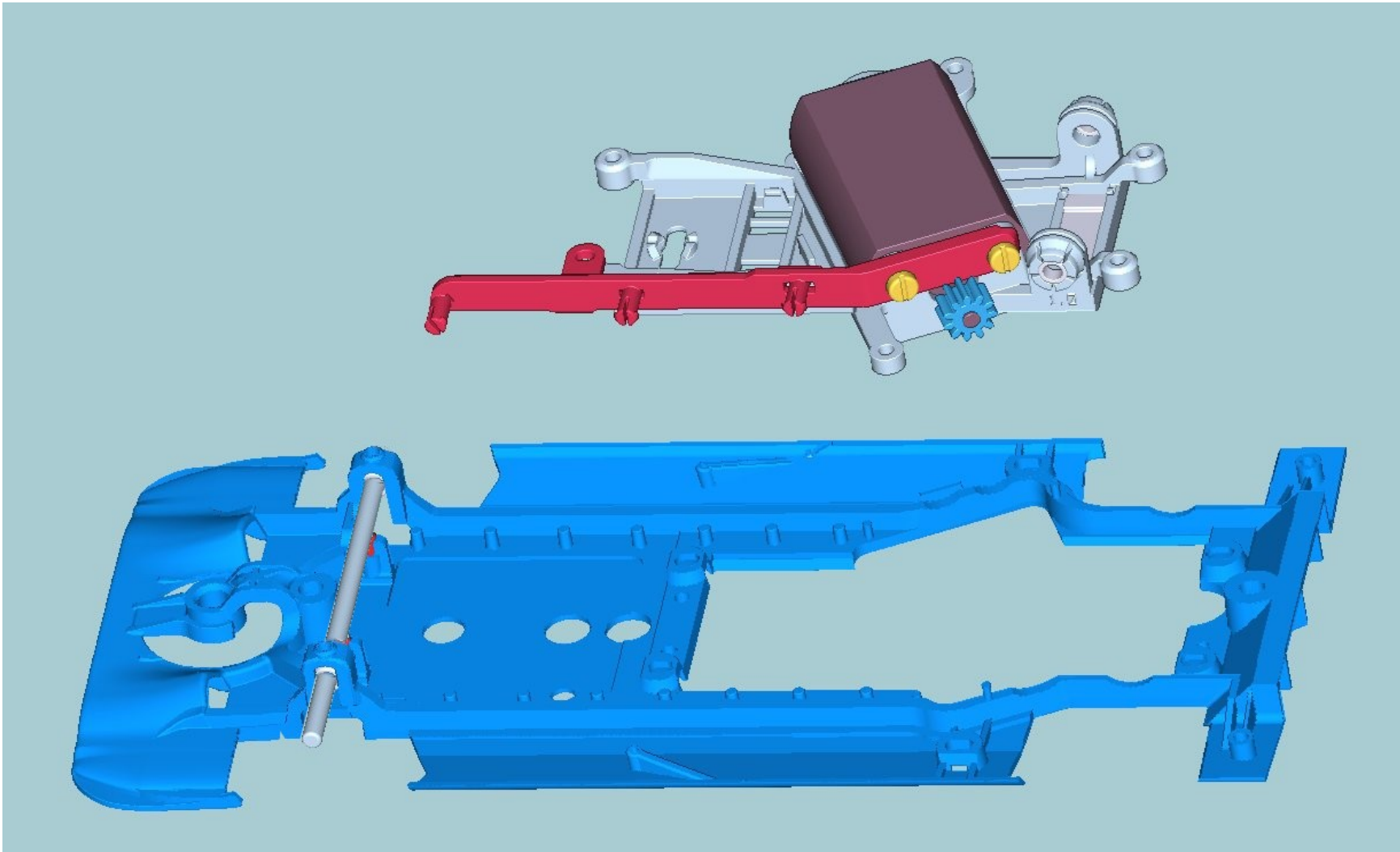

18) add motor mount assembly (use 2 body type screws at front of the motor mount, and 4 standard motor mount screws for the rest - side and rear. See image in next slide)

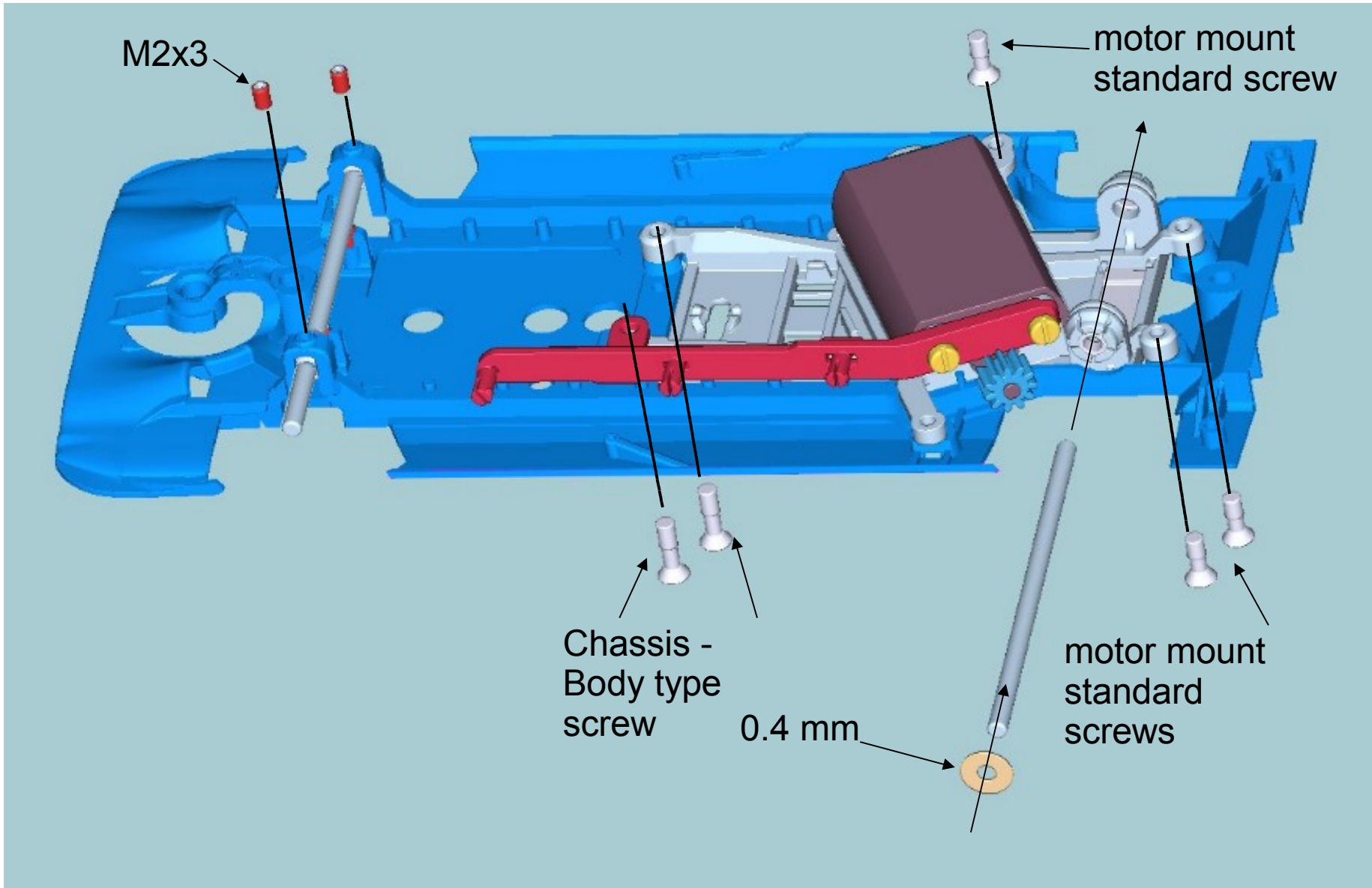

19) add 2 mini screws 3mm on the top of the front shaft, and insert 0.4 mm rear spacer

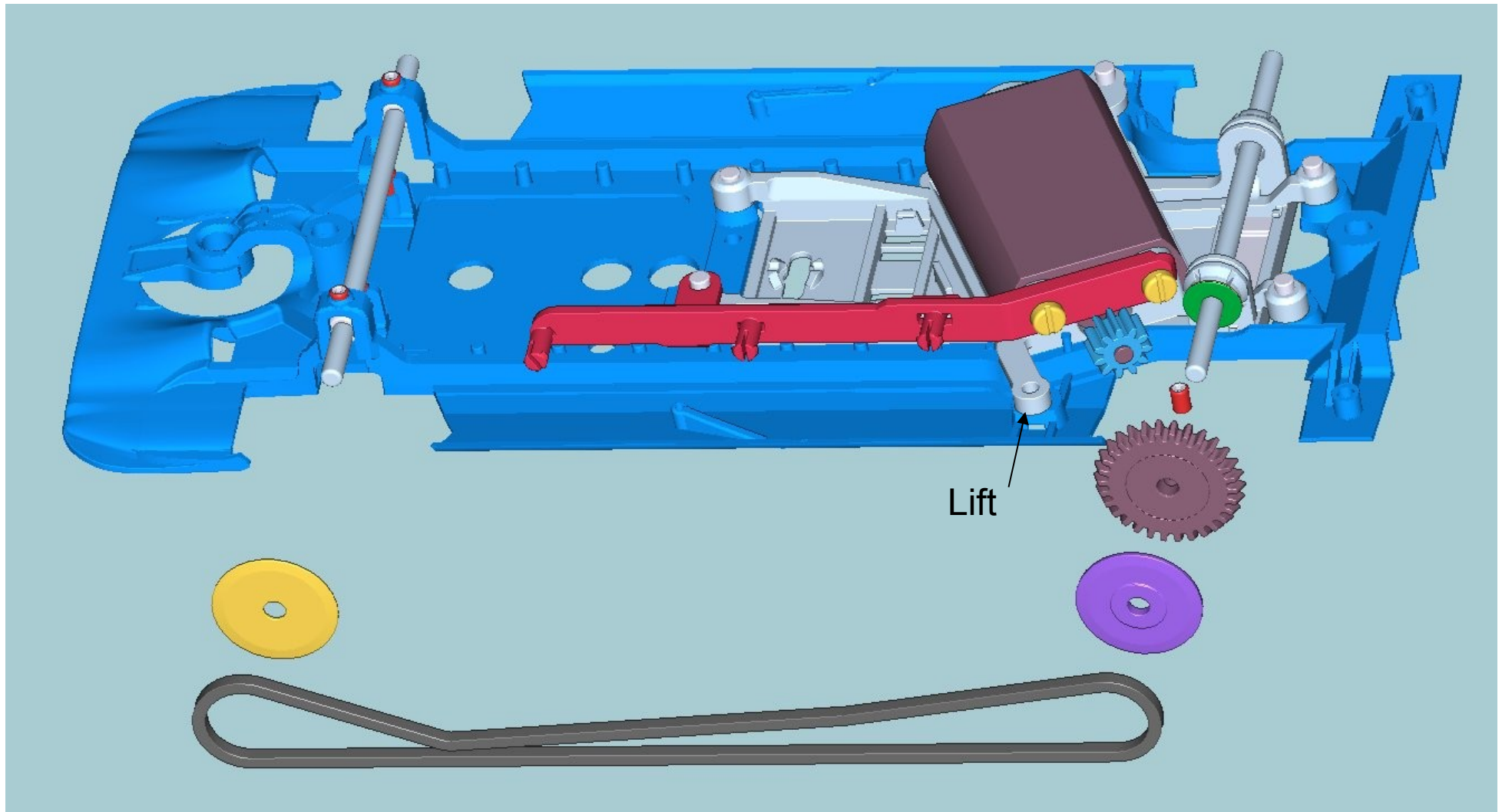

20) insert yellow Z28 crown with mini screw.  
Add front 0.3 flange spacer and rear 0.7mm flange spacer  
Lift the left side motor mount screw post and insert the toothed belt

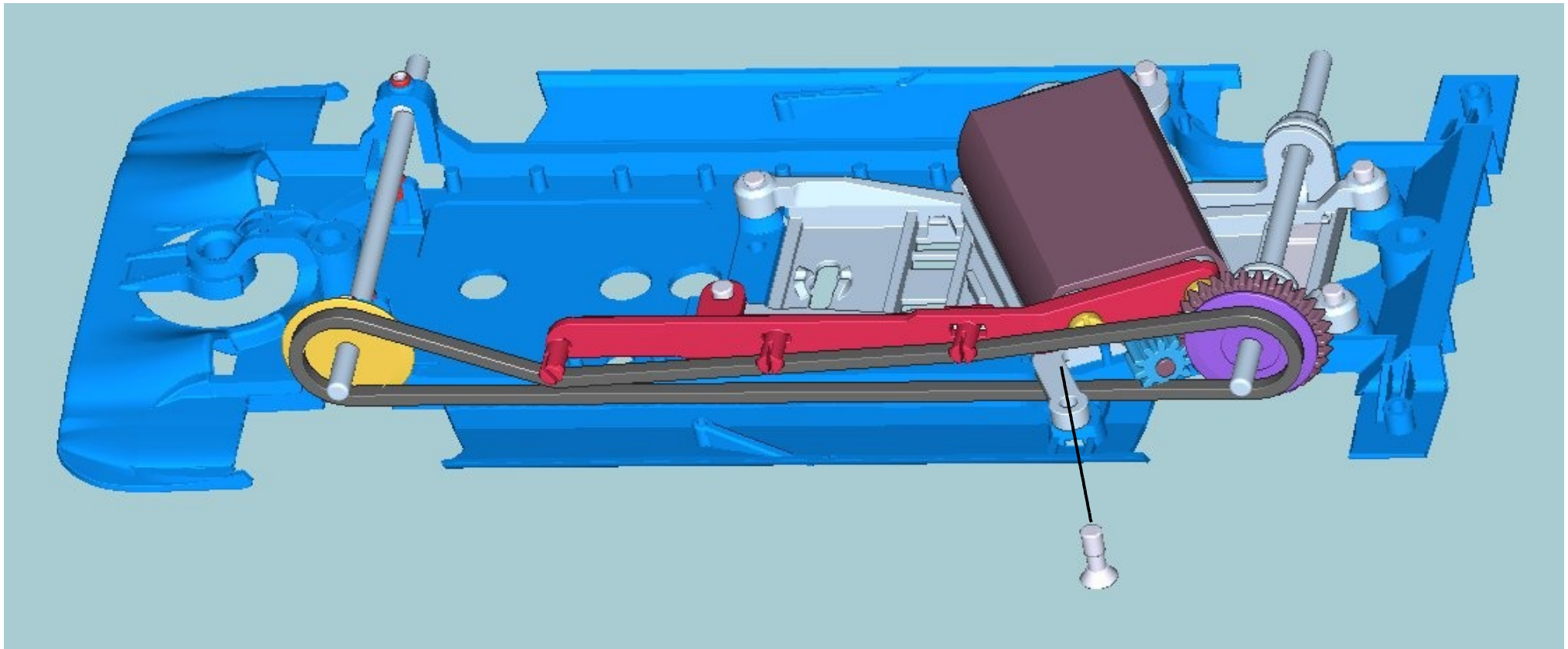

21) add last motor mount screw

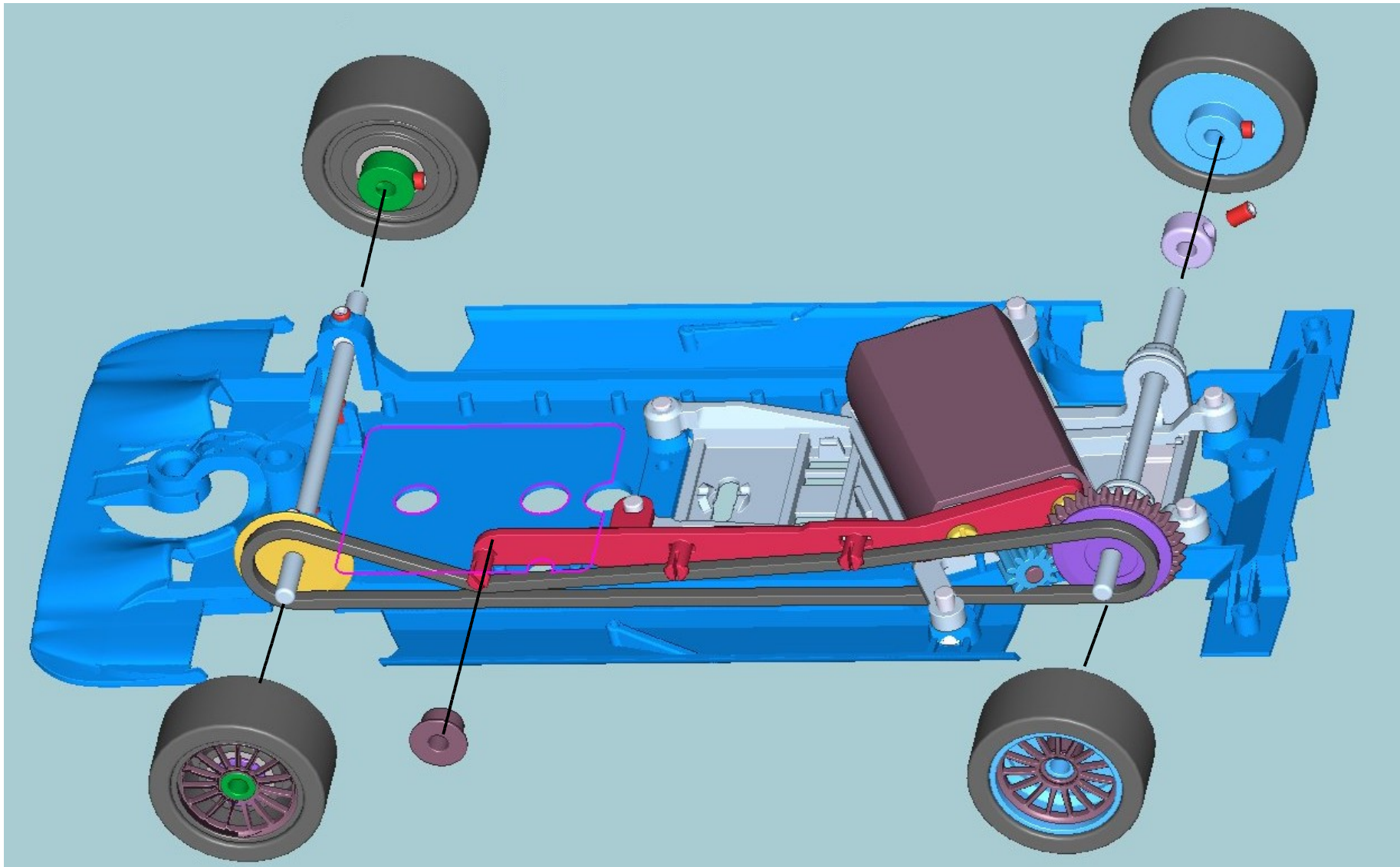

22) insert the flanged plastic bearing on the tensioner. Add the **RIGHT** wheel and the **LEFT** wheel. Add rear stopper and right wheel, with mini screws. Now assemble the left wheels, making sure the belt is in the proper place on the pulleys!!



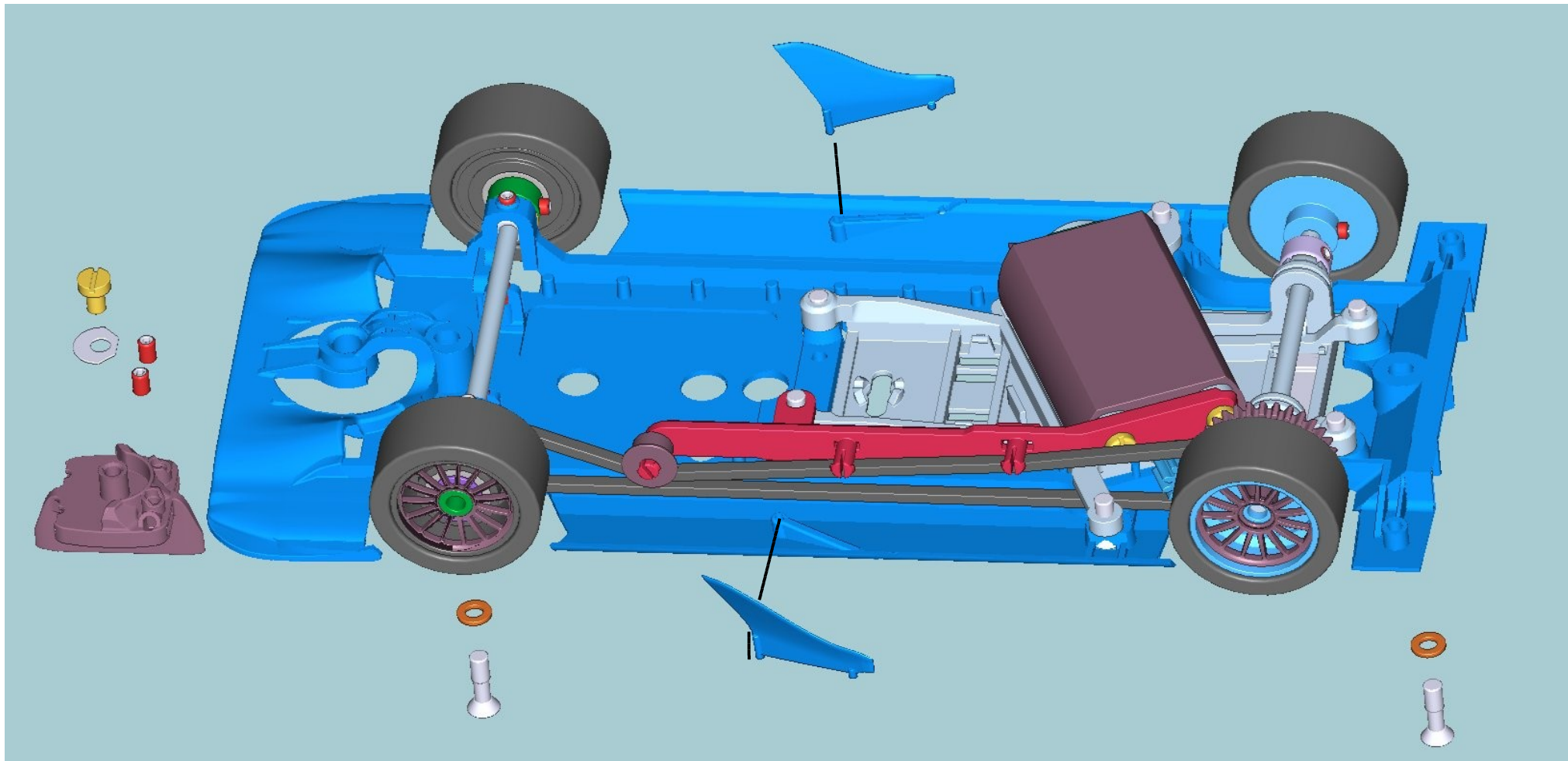

23) add pickup, side fins, and assemble to body.